



Serie

Silver - 76 RPT

Especificaciones Técnicas

Carpintería Corredera

Cerco y Hoja Perimetral

Sección de Marco 80 mm.

Sección de Hoja 32 x 77 mm.

Galce de vidrio Vidrios hasta 26 mm. (29 mm. de hueco)

Peso Máximo por Hoja : 180 Kg. (2 tándems por hoja)

Posibilidad de colocación de Herraje Multipunto Corredera

Clasificación obtenida

| | | |
|------------------------------------|-------|-------------------------------|
| Permeabilidad al aire* | CLASE | 3 |
| Estanqueidad al agua* | CLASE | 7A |
| Resistencia al viento* | CLASE | C5 |
| Transmitancia térmica** | | 1.6 W/m ² K |
| Transm. térmica Uf (Nudo lateral)^ | | 3.9 W/m ² K |
| Aislamiento Acústico*** | | 38 (-1,-2)dB |

* Ventana de 2 hojas de 1230 x 1480 mm .

** Ventana de 2 hojas de 1480 x 2180 mm ; Vidrio Ug: 0,8 W/m² K

*** Ventana de 2 hojas de 1250 x 1500 mm ; Vidrio 4+4.2 Silence/10/3+3.2 Silence

^ Según normativa UNE-EN ISO 10077-2

Posibilidades de Apertura

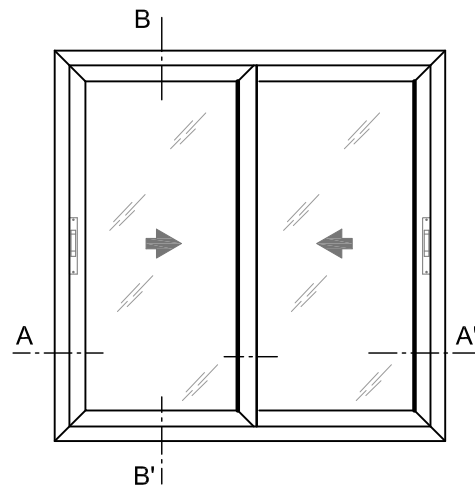
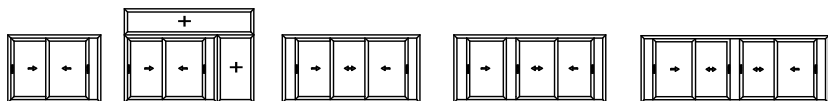

VENTANA DE 2 HOJAS CORREDERAS

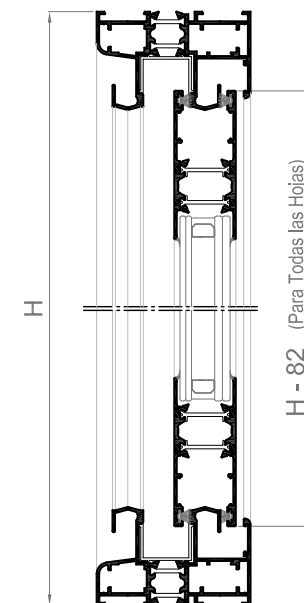

Sección B-B'

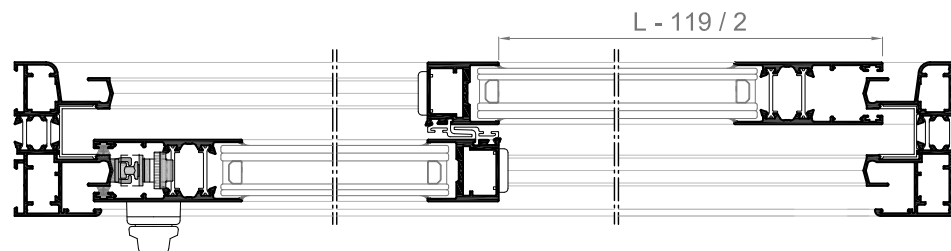

Sección A-A' / Hoja Minimalista

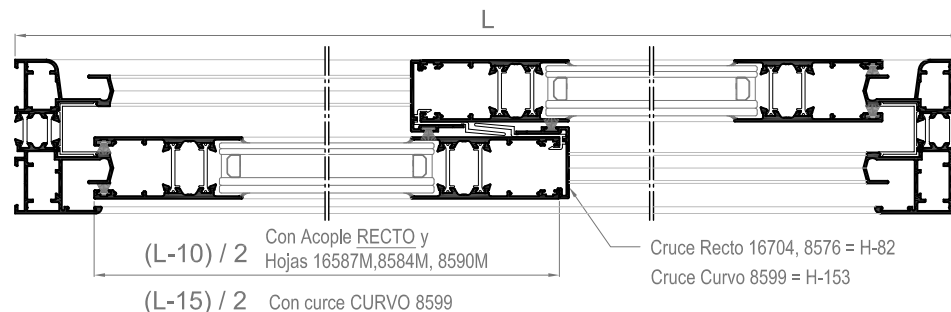

Sección A-A'

Los ensayos de las ventanas realizados por el grupo Alugom, que son cedidos para la obtención del marcado CE por parte del cliente, se han realizado con los perfiles y accesorios específicos y concretos propuestos por el grupo Alugom, que figuran en los manuales de fabricación de cada serie. Para más información consultar con la sección técnico-comercial del grupo Alugom.

Perfiles

Silver - 76 RPT

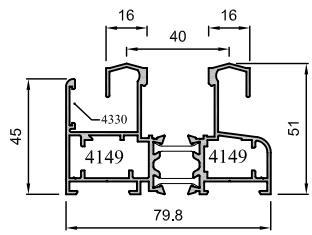

8064M

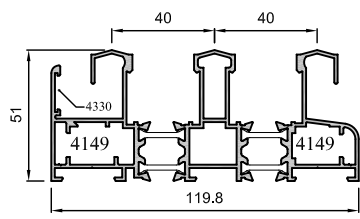

8065M

c/ útil 4386 con lengüeta de 17 (No Incl.) ó
c/ útil 4192 (posterior a 2010).

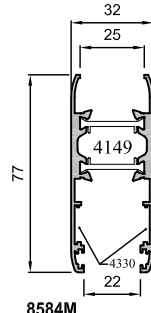

8584M

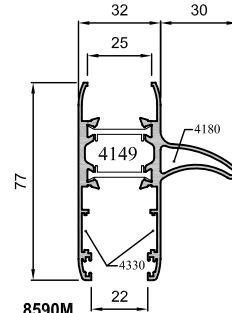

8590M

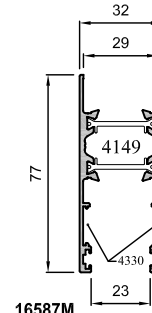

16587M

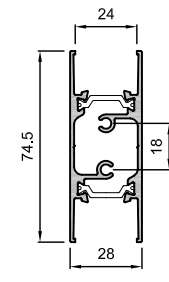

10005M

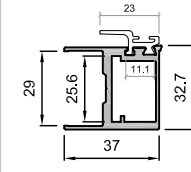

17259M

mecanizado manual

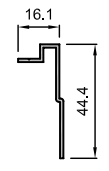

8577

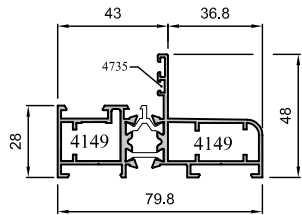

8062M

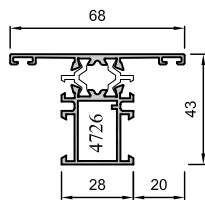

8865M

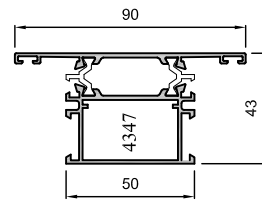

8810M

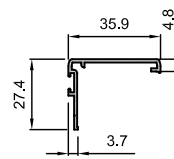

8576
Cruce 4135

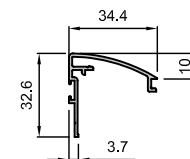

8599
Cruce 4133

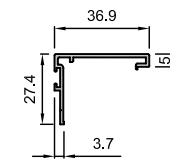

16704
Acople para hoja recta (16587M)
Cruce 4135

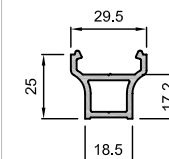

783
6695

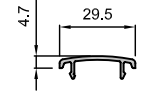

784
6696

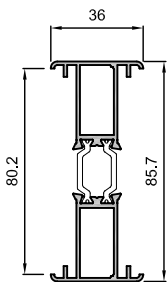

8099M

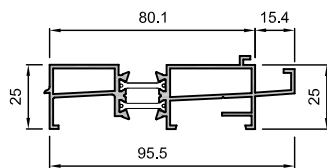

8619L

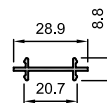

8589

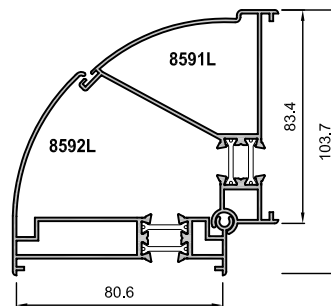

327
1434

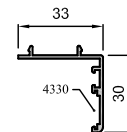

281
1140

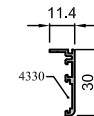

8629

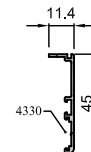

8832

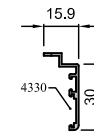

8630

Accesorios

Silver - 76 RPT

Tirador

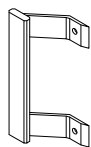

4153
Tirador Series Silver

Escuadras



4149
Escuadra Cerco y Hoja



4136
Escuadra Cerco 3 Carriles



4330
Escuadra alineam. 15 mm.



4735
Escuadra alineam. 2 mm.



4109
Escuadra alineam. hojas



4039
Escuadra inox. alineamiento

Tapas

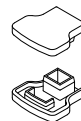

4339
Jgo. tapas tirador postizo (783-4)

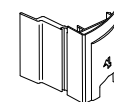

4199
Emb. acople curvo (para 8599) (Jgo.4)



4155
Emb. acople H. central

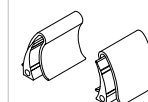

4185
Juego tapas hoja tirador (8580)



4337
Emb. salida agua c/membrana



4035
Emb. salida agua

Elementos de Cierre

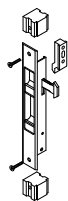

4550
Cierre Embutido s/condena

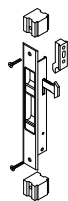

4557
Cierre embutido c/condena

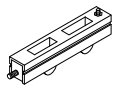

4140
Rueda regulable 160Kg por hoja (2 tandem)



4147
Rueda sencilla 80Kg por hoja (2 ruedas)

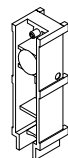

4184
Tope Guiador (Jgo. 4)



4197
Perfil aislante acople 4 hojas



4134
Perfil aislante cerco



4135
Perfil aisl. acople central recto



4133
Perfil aisl. acople central curvo

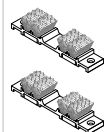

4141
Cortavientos Silver-76



2004
Cepillo Corr. 7x6 mm.



2022
Cepillo Fin Seal 7x7 mm.



3204
Cepillo Fin Seal 7x6.5 mm.



4177
Cepillo Tri-Fin 7x6 mm.

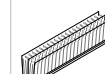

4179
Cepillo Tri-Fin 7x7 mm.

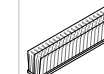

4178
Cepillo Tri-Fin 7x6.5 mm.



4176
Valvula de drenaje

Cierre Multipunto c/ llave

E : 15 mm

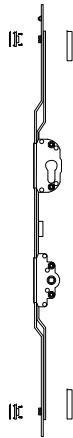

4186
Cierre multipunto con llave
Longitud = 1600 mm.

Cierre Multipunto

E : 7.5 mm

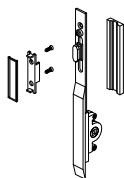

4193
Cierre multipunto 125 (monopunto)

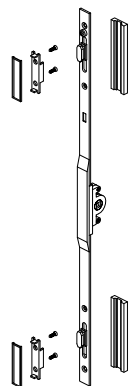

4187
Cierre multipunto H= 668 - 1068

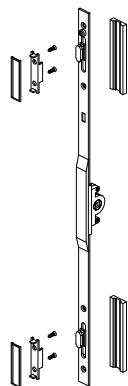

4188
Cierre multipunto H= 1069-1868

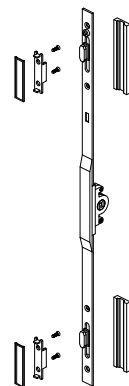

4189
Cierre multipunto H> 1869

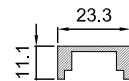

Calzo grande

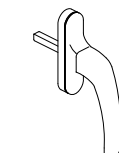

4190
Manilla cuadradillo 7 mm.

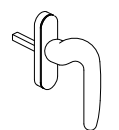

4858(D) / 4859(I)
Manilla corredera acodada cuadradillo 7 mm.



4979
Seguro antielev. multipunto



5086
Manilla recta acodada

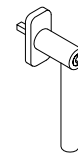

5080
Manilla recta c/llave

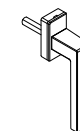

5191
Manilla Kora c/cuadr. 7mm



5079
Manilla recta cuadradillo 7 mm



5183
Manilla cuadradillo 7 mm c/llave

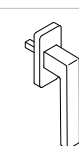

5389
Manilla Toulon c/cuadr. 7 mm.

KITS

4181
KIT Escuadra Hoja Minimalista

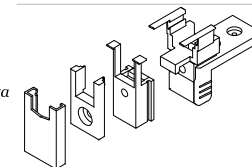

Utilaje

- 4192 Útil Silver- 76 / 76 rpt
- 4386 Útil manual Silver - 76 / 76 rpt
- 5476 Útil manual escuadras
- 5477 Útil hoja minimalista (17259M)